

## VERS-A-LIFT

**Powerful, easily portable models with or without built-in Rectifier\***

Ohio's electric **VERS-A-LIFT** magnets are powerful for their size. Designed to lift, hold and transport castings, plates, burn-outs and machined steel parts. They are easily portable and extremely maneuverable. You'll use these light weight magnets anywhere inside or outside your plant. Lifting capacities range from 350 to 6,320 pounds and are available in diameters of 4, 7, 10, 12, & 15 inches.

Ideal for use on jib cranes Ohio's **VERS-A-LIFT** magnets attach quickly and easily through a 1 inch I.D. lifting ring. Models with built in rectifiers can be plugged directly into 115 VAC wall outlets.

**VERS-A-LIFT** magnets are used in multiples with spreader beams as a low cost alternative for transporting thin long sheet steel which may flex or bow.

Adaptable to your power source, **VERS-A-LIFTS** are available in standard DC voltage or with built-in rectifiers. Separate rectifiers are also offered.

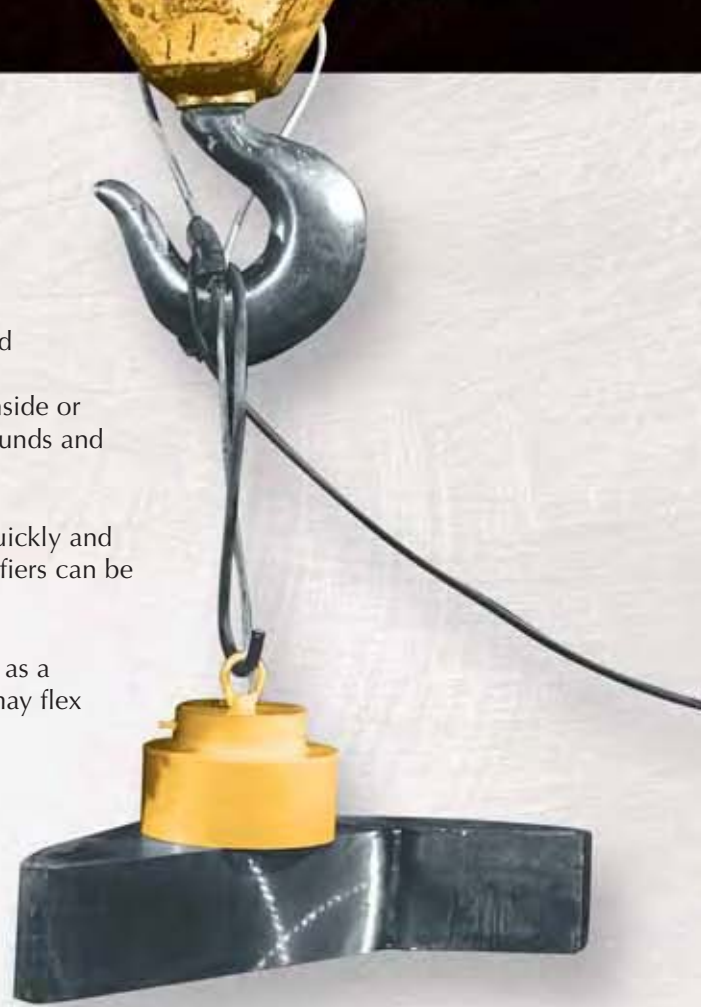

MODELS WITH BUILT-IN RECTIFIERS (115 V.A.C. SINGLE PHASE, 60HZ)							
SIZE (Dia.)	B	C	D	E	F	G	Net Weight (Lbs.)
7"	8-11/16	4-7/16	2-1/4	1-1/2	1-1/4	3/8	38
10"	9-5/8	4-5/8	2-7/8	1-3/4	1-1/2	1/2	87
12"	10-1/8	4-3/4	2-7/8	1-3/4	1-1/2	1/2	120
15"	10	5-1/4	3-3/4	1-3/4	1-1/2	1/2	235

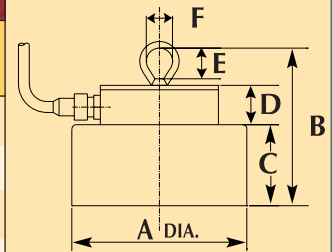

MODELS OPERATING ON STANDARD D.C. VOLTAGE [115V.D.C. EXCEPT 4" (12 V.D.C.)]							
SIZE (Dia.)	A	B	C	D	E	Watts Intermittent	Net Weight (Lbs.)
4"	4	5-1/32	3-5/8	1-3/16	7/16	40	11
7"	7	5-27/32	4-7/16	1-3/16	7/16	114	34
10"	10	6-7/16	4-5/8	1-1/2	21/32	201	78
12"	12	6-9/16	4-3/4	1-1/2	21/32	261	112
15"	15	7-1/16	5-1/4	1-1/2	21/32	392	212

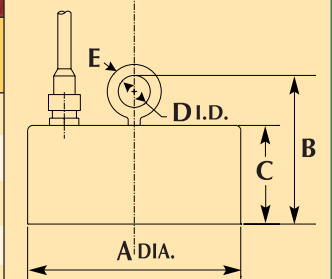

\* Suitable rectifiers available on request.

PULL DATA					
Size (O.D.)	4"	7"	10"	12"	15"
Max. Force (Cold) Lb. Theoretical	612	2,380	5,675	6,950	11,150
Max. Force Hot 75% Theoretical	344	1,740	3,290	3,900	6,290
Min. Plate Thickness (Zero Air Gap Direct Contact Max. Force)	3/4"	1"	1-1/4"	1-1/2"	1-3/4"